

JACK

China No.1

Shanghai stock
listed



Jack Wechat



Jack Facebook



Computerized Double Needle Lockstitch Machine



2019.09

JACK SEWING MACHINE CO.,LTD.

No. 15 South Airport Road, Jiaojiang District, Taizhou, Zhejiang, PRC
TEL: 0086-576-88177782 88177767
FAX: 0086-576-88177787

E-mail: sales@chinajack.com
www.chinajack.com

JK-58450J

JK-58450J

Item: Computerized Double Needle Lockstitch Machine
 Features: Auto Cornering; Large Space



1 Electronic Thread Tension

2 Auto Cornering

3 Needle Gage

4 Voice Guide

5 Reset

6 USB



2 Auto Corner Sewing (model with 415 E/413E)

Split needle bar, positioning accurately, easy to operate.



3 Voice Guide, One Key to Reset

Users can reset to factory parameters or set parameters according to their needs; 12 languages and easy to operate.

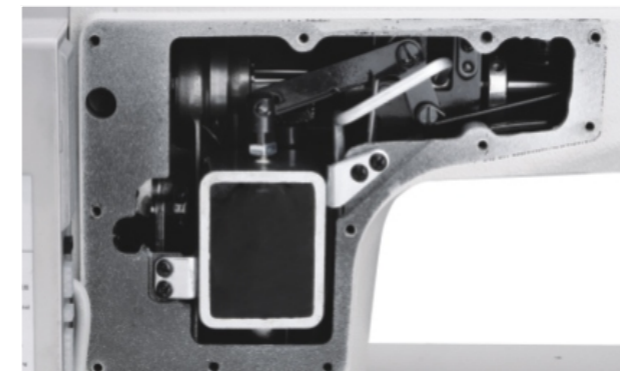

4 Built-in Presser Foot Lifter

Easy to operate, save man-power, more stable.

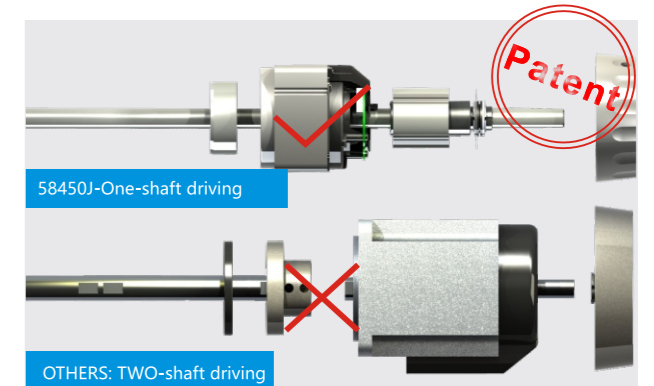

5 One main shaft, stable and fast

Reduce the machine torque, making the sewing fast, stable and durable.

Advantage



Cutting For Thick And Thin Thread

1 Straight Knife

For different thickness of thread.

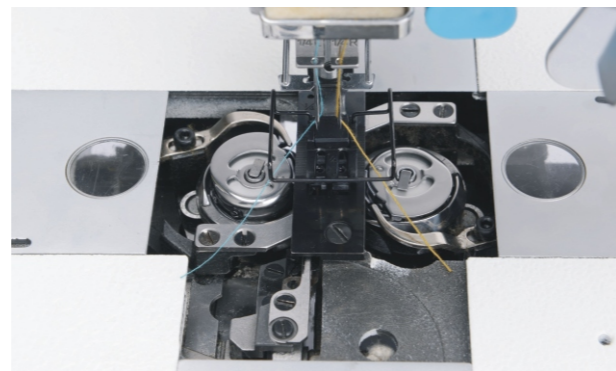

Straight Knife

Specification

Model	Needle	Stitch Length (mm)	Needle Gauge (mm)	Presser Foot Lifting Height (mm)	Max. Speed (s.p.m)	Application	Function	Auto Corner Sewing	Large Hook	Volume (mm)	Weight (kg)
JK-58420-003/JK-58420-005	DP×5 11-16#/14-22#	4/5	6.4	7-13	3000	Light/Heavy Duty	Straight Stitch			725×320×675	43/53.5
JK-58450-003/JK-58450-005	DP×5 11-16#/14-22#	5	6.4	7-13	3000	Light/Heavy Duty	Corner Stitch			725×320×675	43/53.5
JK-58720-003/JK-58720-005	DP×5 11-16#/14-22#	7	6.4	7-13	3000	Light/Heavy Duty	Straight Stitch		✓	725×320×675	43/53.5
JK-58750-003/JK-58750-005	DP×5 11-16#/14-22#	7	6.4	7-13	3000	Light/Heavy Duty	Corner Stitch		✓	725×320×675	43/53.5
JK-58420J-403E/JK-58420J-405E	DP×5 11-16#/14-22#	4/5	6.4	7-13	3000	Light/Heavy Duty	Straight Stitch			725×320×675	53/63
JK-58450J-403E/JK-58450J-405E	DP×5 11-16#/14-22#	5	6.4	7-13	3000	Light/Heavy Duty	Corner Stitch			725×320×675	53/63
JK-58450J-413E/JK-58450J-415E	DP×5 11-16#/14-22#	5	6.4	7-13	3000	Light/Heavy Duty	Corner Stitch	✓		725×320×675	53/63
JK-58720J-403E/JK-58720J-405E	DP×5 11-16#/14-22#	7	6.4	7-13	3000	Light/Heavy Duty	Straight Stitch		✓	725×320×675	53/63
JK-58750J-403E/JK-58750J-405E	DP×5 11-16#/14-22#	7	6.4	7-13	3000	Light/Heavy Duty	Corner Stitch		✓	725×320×675	53/63
JK-58750J-413E/JK-58750J-415E	DP×5 11-16#/14-22#	7	6.4	7-13	3000	Light/Heavy Duty	Corner Stitch	✓	✓	725×320×675	53/63

Note: 1.B is direct drive, Chinese hook is standard; the imported hook can be optional. 2.J is computerized, auto trimmer, auto reverse, auto presser foot lifter, auto wiper are as standard; the electronic thread tension is optional, the model is 413E/415E.